

Rooflight with pleated blind and net
for installation in caravans and mobile homes



MPK Metall- und
Plastikverarbeitung GmbH & Co. KG
Friedrich-Ebert-Str. 298-300
D-58566 Kierspe
mpk-kierspe.de

VisionStar M pro II LED



Aperture	400 x 400 mm
Roof thickness	25 bis 60 mm
Corner radius	28 mm
Site dome	490 x 470 mm
Height over roof	80 mm
Ventilation	0 bis 150 cm ²
Weight	3,8 kg
Size inner frame	585 x 570 x 35 mm
Outer frame material	Polypropylene
Dome material	Polycarbonate
Speed limit	160 km/h
Authorization	ECE R43 -019651
<u>LED-light</u>	
Light color	~ 3000 K (warmwhite)
Energy efficiency class	F
Nom. useful luminous flux	2 x 490 lm
Voltage	12V DC
Consumption	2 x 4 kW/h / 1000h
Nominal lifetime	50.000 h
Dimensions	400 x 10 mm

Technical data:

Included with delivery

- 1x Rooflight with outer frame
- 1x Inner frame with LED, polyswitch fuse, connection cable
- 1x Fixing parts (8x fixing brackets and 4x large plastic screw)

Additionally required for installation (not included in delivery)

- 1x Elastic sealant adhesive, e.g. Dekalin Dekaseal 8936 or SikaLastomer®-710
- 8x Fixing screws for the upper frame
Pan 3,5 mm / head according to DIN ISO 7049 (DIN 7981) / The length of the screw should be determined by the roof thickness, plus approximately 10 mm for the screw to enter the upper frame.
- With timber support under the roof lining:
- 4x Fixing screws for the inner frame:
Pan 3,5 mm / head according to DIN ISO 7049 (DIN 7981) / length max. 10 mm

Explanation of symbols



NOTE
Particularly important information.



ATTENTION!
Failure to observe can lead to material damage.



WARNING!
Safety note: Serious risk of injury.

Safety and installation instructions

- Check the roof thickness of your vehicle before mounting.
- **The rooflight should only be fitted to a flat roof surface, both internally and externally.**
- Choose a fitting position that will not interfere with other roof mounted components (e.g. roof-racks/antenna's etc.) and avoid internally installed electrical cables and furniture, which could impede the correct operation of the rooflight.

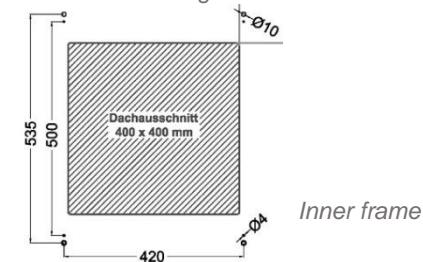

EN Installation and Operating Instructions

Please read the instructions carefully before installing the rooflight and store it for future.



We cannot be held responsible for incorrect fitting, handling or operation. Any product faults relating to the production and materials used should be notified to us via an authorised dealer immediately.

- Make sure that there is a suitable supply line and switch for the lighting in the vehicle.
- We recommend installation with the hinge side in the direction of travel.
- Never stand on the dome of the rooflight!

! Do not open the rooflight while driving. The rooflight must be locked down before traveling.

- Do not open the rooflight in strong wind or rain .
- Close the rooflight during rain and snowfall.

Installation



Please clean the frames carefully before mounting the sealant.



! Follow the instructions of the sealant manufacturer.

Separate the inner and outer frames and fit the outer frame to the outside of the roof aperture onto a bed of sealant. **Hinge side in the direction of travel!**

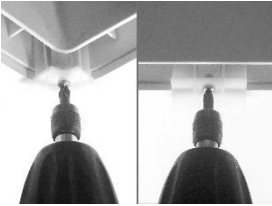

Place over the screw holes on the inside of the frame, the 8 fixing brackets; four in each corner, four in the centre of each side. Secure with screws, stop as soon as the brackets start to distort.

! Max. Torque 0.5 Nm.

Remove the small tabs on the corner bracket before installing the inner frame.

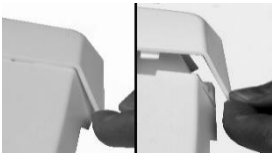

To fit the inner frame, gently pull out the pointed ends of the cover profiles to release them and reveal the fixing points.



! Turn off the power supply in the vehicle before proceeding with the connection of the LED lighting.

Connect the supplied connection cable to the power supply installed in the vehicle.

Connect the Polyswitch cable of the inner frame to the power supply of the vehicle. Then place the inner frame in the centre of the cutout.

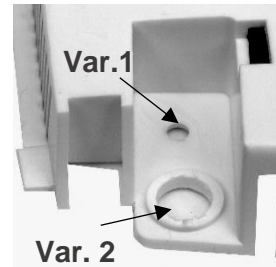
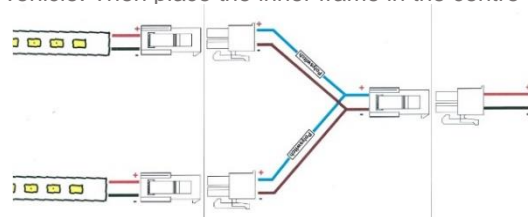

Version 1: Timber support under the roof lining

Offer up the inner frame into the outer frame. Use the four small holes to fix the inner frame with standard screws into the timber support.



Version 2: Inner lining made of plywood / polyester layer

Offer up the inner frame into the outer frame and mark drill holes (large screw hole). Pre-drill the screw holes and screw the inner frame tight with the supplied plastic screws.



Fix the connector from the inner frame with the connector from the side panel before inserting the side cover.

Refit the inner frame covers by locating the securing lugs and keeping the covers parallel against the roof whilst sliding them carefully onto the frame, 'clicking' back into position, without distorting.

Permanent ventilation

The rooflight is optionally available with or without permanent ventilation. If required, the permanent ventilation can be retrofitted (see Extras).



Without free-air-flow

Rubber seal 160 cm all around



With free-air-flow 75cm²

Rubber seal shortened to 90 cm
Hinge side

2x buffer piece (inserted with longer side inwards)
rear



With free-air-flow 150 cm²

Rubber seal shortened to 34 cm
Hinge side

2x buffer piece (inserted with longer side inwards)
rear

Operation



To open the rooflight, both pleated blinds must be open.

Grip the crossbar in the middle and turn it towards the opening side. Now the rooflight can be opened by pushing the crossbar. As soon as you release the crossbar the opening mechanism snaps into this position.

To close the rooflight, turn it again and push it back in the opposite direction. When the end position is reached, the rooflight is locked automatically.



- Keep the pleated blinds open while driving to avoid driving noise and damage from the airstream.
- To avoid heat accumulation do not close blind completely during the day. Open both pleats when not using the vehicle.

Cleaning

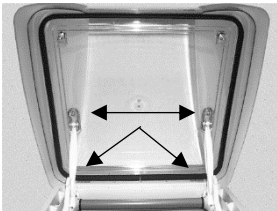

For easier cleaning, the dome can be removed from the inner frame by releasing the four plastic split pins.



Do not loosen any screws that are used to fasten the dome or the opening mechanism.

Use only clear water and a soft sponge.



Solvents may attack the plastic and make it brittle.

After cleaning, maintain the sliding surfaces with a thin layer of Vaseline or WD40. This makes the extension mechanism glide more easily. The rubber seals can be maintained with talcum powder.

Pay attention that the pins positively click into the locked position when re-installing the dome. The lever arm pins should be re-installed with the flat side towards the dome.

Clean the pleated blinds with a soft brush, dry cloth or feather duster.



We strongly advise against wet cleaning, as this can damage the insect screen and blackout pleated blind.

Extras (optional)

Designation	Article No.
Adapter frame for Fiat Ducato	4040ARW
Rubber seal without permanent ventilation	4901.11
Rubber seal permanent ventilation 75cm ²	4901.11-75
Rubber seal permanent ventilation 150cm ²	4901.11-150

Warranty

The legal warranty applies.

Disposal



Articles and packaging must be disposed of in accordance with local legal requirements, as well as regulations for the disposal of plastics, electrical waste and packaging.



mpk-kierspe.de/Downloads